



# ZENLABS HOLDINGS INC.

Providing the cannabis industry clean reliable young plants



# Safe Harbor Provision and Forward Looking Statement Disclaimer

This document is a presentation (the “Presentation”) providing general background information about ZenLabs, Inc. (“ZLI” or the “Company”) as of April 15, 2019.

It is information in a summary form and does not purport to be complete. It is not intended to be relied upon as advice to investors or potential investors and does not take into account the investment objectives, financial situation or needs of

any particular investor. These should be considered, with or without professional advice, when deciding if an investment is appropriate.

This Presentation does not constitute or form part of any offer for sale or solicitation of any offer to buy or subscribe for securities nor shall it or any part of it form the basis of or be relied on in connection with, or act as any inducement to enter into, any contract or commitment whatsoever. Recipients of this Presentation who are considering acquiring securities of ZLI are reminded that any such purchase or subscription must not be made on the basis of the information contained in this Presentation but are referred to the entire body of publicly disclosed information regarding ZLI. Please refer to the Company’s Website at: [www.zenlabsca.com](http://www.zenlabsca.com)

The information contained in this Presentation is derived solely from management of ZLI and otherwise publicly available information concerning ZLI and does not purport to be all-inclusive or to contain all the information that an investor may desire to have in evaluating whether or not to make an investment in ZLI. The information has not been independently verified and is subject to material updating, revision and further amendment, and is qualified entirely by reference to ZLI’s publicly disclosed information. No representation or warranty, express or implied, is made or given by or on behalf of ZLI or any of its affiliates, directors, offers or employees as to the accuracy, completeness or fairness of the information or opinions contained in this Presentation and no responsibility or liability is accepted by any person for such information or opinions, ZLI does not undertake or agree to update this Presentation or to correct any inaccuracies in, or omissions from, this Presentation that may become apparent. No person has been authorized to give any information or make any representations other than those contained in this Presentation and, if given and/or made, such information or representations must not be relied upon as having been so authorized.

The information and opinions contained in this Presentation are provided as at the date of this Presentation. The contents of this Presentation are not to be construed as legal, financial or tax advice.

Each prospective investor should contact his, her or its own legal adviser, independent financial advisor or tax advisor for legal, financial or tax advice. Certain statements in this Presentation may constitute forward-looking information, including future- oriented financial information and financial outlooks, within the meaning of applicable securities laws. Forward-looking information may relate to ZLI’s future outlook and anticipated events or results and may include statements regarding ZLI’s financial results, future financial results, future financial position, expected growth of cash flows, business strategy, budgets, projected costs, projected capital expenditures, taxes, plans, objectives, potential synergies, industry trends and growth opportunities. Often but not always, forward-looking information can be identified by the use of words such as “anticipate”, “believe”, “expert”, “project”, “estimate”, “likely”, “intend”, “should”, “could”, “may”, “might”, “target”, “plan” and other similar expressions or variations (including negative variations) of such words and phrases. Forward-looking information contained in this Presentation is based on certain assumptions regarding expected growth, results of operations, performance, industry trends and growth opportunities.

This information is based on current expectations that are subject to significant risks and uncertainties that are difficult to predict, including: (i) the Company’s ability to obtain the requisite regulatory approvals in California and the United States, including approvals from any Canadian stock exchanges, Health Canada, the Colombian Government and all regulatory agencies and bodies in Colombia; (ii) the Company’s ability to enter into any definitive sales agreements; (iii) the agricultural risks associated with cannabis production in California and (iv) the ability to sell propagation services and cannabis/hemp at competitive price points. Actual results might differ materially from results suggested in any forward- looking statements.

Although SMLS has attempted to identify important factors that could cause actual actions, events or results to differ materially from those described in forward-looking statements, there may be other factors that cause actions, events or results to differ from those anticipated, estimated or intended. Forward- looking statements contained herein are made as of the date hereof and SMLS and its directors, officers and employees disclaim obligation to update any forward-looking statements, whether as a result of new information, future events or results or otherwise. There can be no assurance that forward-looking statements will prove to be accurate, as actual results and future events could differ materially from those anticipated in such statement. Accordingly, you should not place undue reliance on forward-looking statements due to the inherent uncertainty therein. All forward- looking information is expressly qualified in its entirety by this cautionary statement.

Forward-looking information and other information contained herein concerning management’s general expectations concerning the cannabis industry are based on estimates prepared by management using data from publicly available industry sources as well as from market research and industry analysis and on assumptions based on data and knowledge of this industry which management believes to be reasonable. However, this data is inherently imprecise, although generally indicative of relative market positions, market shares and performance characteristics. While management is not aware of any misstatements regarding any industry data presented herein, industry data is subject to chance based on various factors.

This Presentation may not be reproduced, further distributed or published in whole or in part by any other person. Neither this Presentation nor any copy of it may be taken or transmitted into or distributed in any other jurisdiction which prohibits the same except in compliance with applicable laws. Any failure to comply with this restriction may constitute a violation of applicable securities law.

Recipients are required to inform themselves of, and comply with, all such restrictions or prohibitions and ZLI does accept liability to any person in relation with applicable laws. Any failure to comply with this restriction a violation of applicable securities law. Recipients are required to inform themselves of, and comply with, all such or prohibitions and ZLI does not accept liability to any person in relation thereto.

All references to “\$” herein means the currency of the United States, unless otherwise stated.





# WHO WE ARE

**With Over 7,000 THC licenses issued in California, there is a desperate need for clean, healthy starter plants.**

We at **Zenlabs** are set to supply that need. From tissue culture, pathogen and virus elimination as well as traditional propagation we have the necessary infrastructure to service and supply the THC market. Boosted by a diverse and extensive library of genetics, our team is set to deliver clean, healthy, young plants on scale and on time.



# TISSUE CULTURE ADVANTAGE

- Each plant produced is genetically identical and uniform
- The plants are free of disease and harmful pathogens
- Plants are healthier and more vigorous
- A cleaner starting plant leads to less need for pathogen and pest management



**The Cannabis industry** is currently experiencing widespread problems due to a cannabis virus known as Hop Latent. We at **Zenlabs** are perfectly positioned to service the needs that the cannabis industry needs. With proven protocols and years of experience in both tissue culture, young plant production and nursery operations we have the infrastructure and knowledge to take advantage of these needs.

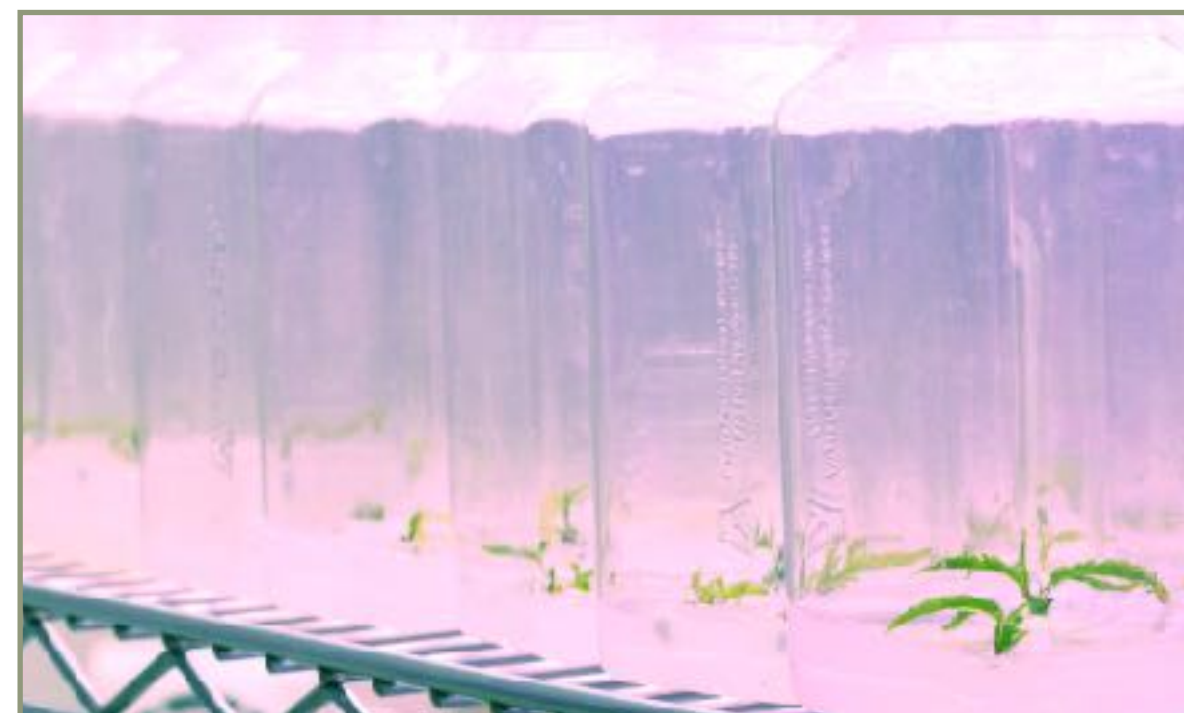

**Pathogen indexing and elimination** will play a large role in the success of cultivators in the years to come. **Zenlabs**, through its network of collaborators, is well positioned to be a front runner in the THC market. California has and will continue to be a leader in agriculture and industry.



# TISSUE CULTURE PROCESS



## Candidate Material

**Cuttings of specific strains from cultivators are taken in.  
This material is tested and prepped for our process  
Each sample strain will have separate needs**



## Tissue Culture Initiation

**The material is then harvested in as many samples as possible.  
These samples are then placed in a media that is specific to  
that materials needs**



## Pathogen Elimination Treatment

**Each strain is then put through our proprietary virus and  
pathogen elimination treatment to ensure that our  
customers are receiving the best chance at success**



# REVENUE STREAMS



## Genetic Banking

**We offer cultivators the ability to off site their genetics and young plant production which allows them to focus that space, labor and materials on what makes them money - Cultivation. They can then utilize 100% of their space**



## Young Plant Production

**We sell young plants to cultivators in the THC market. Our cost and scale coupled with a proprietary tissue culture treatment allows us to deliver healthy young plants on scale and on time**



## Indoor and Greenhouse Cultivation

**With over 25 years of collecting land race as well as crossed varieties of cannabis in THC, we are poised to offer the industry a large library to choose from.**



# CURRENT STATE OF ZENLABS



## THC Market

### Indoor Operations

12,400 sf state-licensed facility in San Diego for:

- Cultivation - DCC
- Nursery - DCC
  - Tissue culture lab
- Distribution - DCC

### Greenhouse Operations

Operational 22,000 sf greenhouse nursery

- Nursery - DCC

Approved plans to develop the first of two sites for a total of over 500,000 sf of operations.



# INDOOR FACILITY

- Tissue Culture Lab and Genetic Banking
- Boutique Top Shelf Flower Cultivation
- Manufacturing and Distribution



# PLANNED OPERATIONS

- Expanding our Greenhouse Nursery and Cultivation
- 22,000sf - 528,000sf Potential Scalability for THC

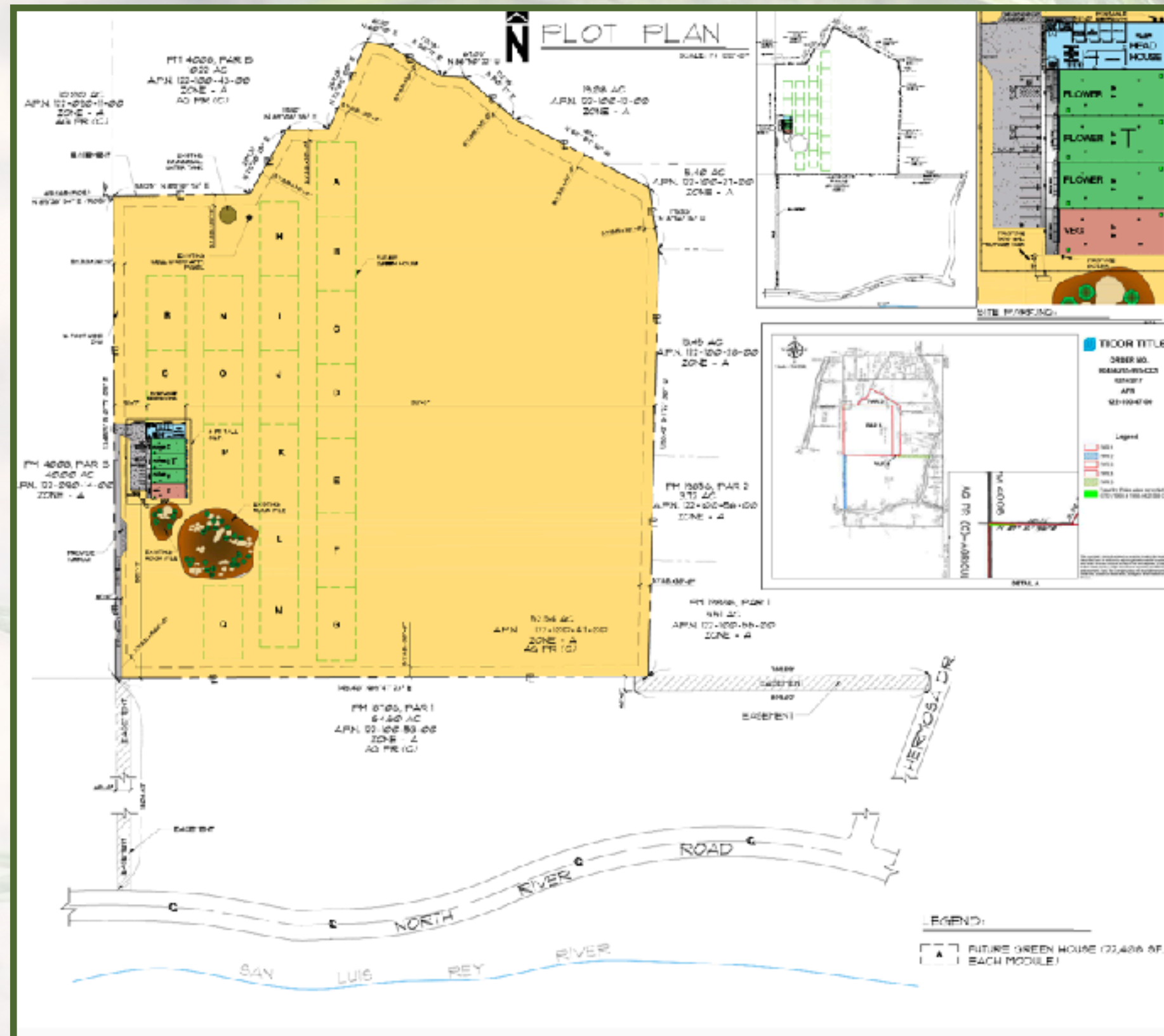



# FUTURE EXPANSION

## CBD and THC Markets

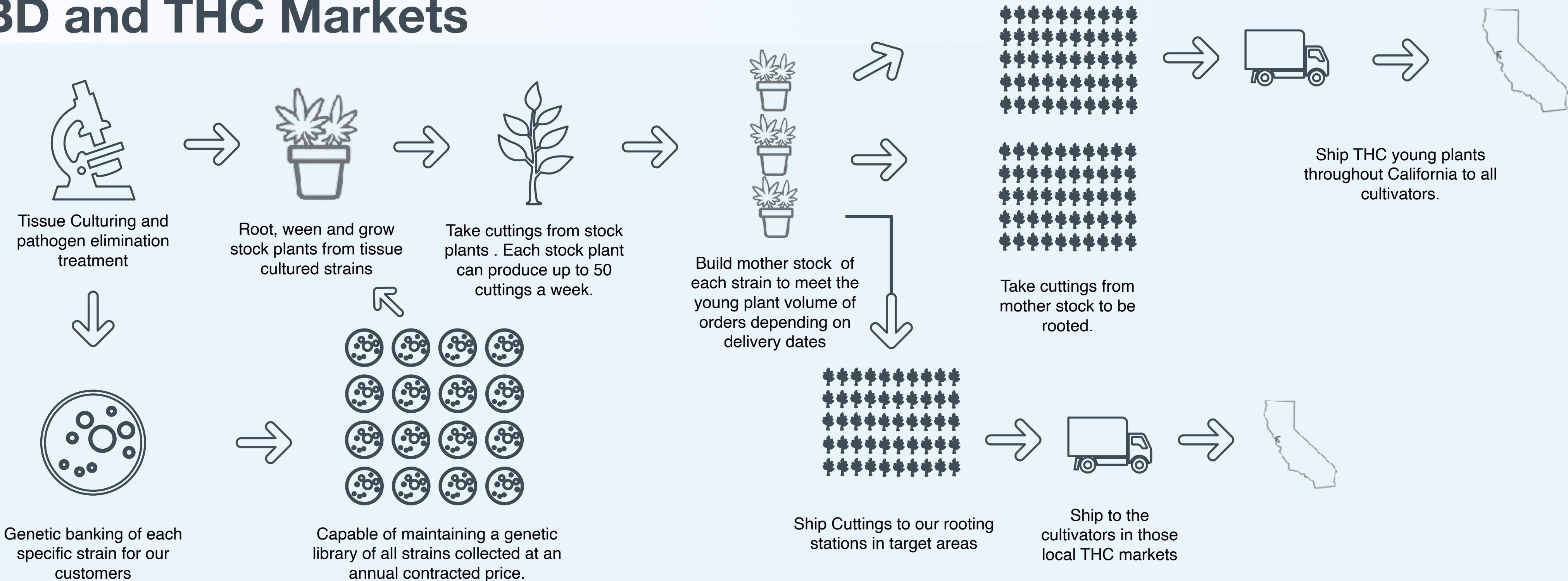

### Revenue

Cost to customers for genetic banking of strains is \$3-\$5,000 annually depending on the amount of young plants customers order

Sale price of rooted young plants \$3 to \$10 depending on variety and quantities ordered.

### Cost

Cost to maintain each variety is around \$600 annually

Cost to produce young plants is around .50 cents





# COMPETITIVE ADVANTAGE

## GENETICS

**ZENLABS**, through its growers, has assembled a genetic library of pheno hunted crosses from the industries top breeders as well as crosses made in house.

**ZENLABS** has the opportunity to develop very unique genotypes. These varieties will be bread to meet the industries increasingly specific needs.

## EXPERIENCE

**ZENLABS** has assembled a direct team with tissue culture, young plant production, cultivation and nursery operational experience. As we grow operationally we have the industry specific collaborators that will enable us to strategically partner for vertical integration in California, the US and globally.

## SCALABILITY

**ZENLABS** has access to some of the regions most ideal land. With access to over 200 acres of current nursery operations and greenhouse space, **ZENLABS** is well positioned in the THC market.

## MARKET SIZE

**ZENLABS** Is positioned to capitalize on the largest cannabis market for THC. California recently surpassed the UK with agriculture playing a part of those statistics. California has always been a leading force in the cannabis space and with a emerging Hemp market **ZENLABS** is positioned for success.

Country	GDP (\$T USD)
United States	\$20,893
China	\$14,722
Japan	\$5,057
Germany	\$3,846
California	\$3,353
United Kingdom	\$2,764
India	\$2,660
France	\$2,630
Italy	\$1,888
Canada	\$1,644
Korea, Rep.	\$1,637

Source: Bureau of Economic Analysis, World Bank

**California Young Plant Needs - Conservative numbers puts the California young plants needs at over 84 Million annually in THC**



# ZENLABS MANAGEMENT TEAM



**Michael Boshart**  
President - Director

- Founder of Zenleaf LLC
- Successful entrepreneur
- 20 years experience
  - Startups
  - General Management
  - Strategic Planning



**Karl Metz**  
COO - Director

- B.S from University of San Diego
- Nursery General Management
  - Over 200 acres in production
  - 25M in gross annual sales
  - 10M+ units sold per year



**Craig Dickhout**  
CMO - Director

- Owner of Think Ink Marketing
- Co-Founder HempLand USA
- Over 20 years experience
  - Marketing
  - General Management
  - Strategic Planning



**Brandon Burrows**  
Head Grower

- 15 years experience in cultivation
- Extensive knowledge in
  - Cannabis Genetics
  - Nutrient mixing and development
  - Soil and hydroponics





# PROJECTIONS

**YOUNG PLANT PRODUCTION - THC** **7.6M** Annually

22,000 SF OF GREENHOUSE NURSERY OPERATIONS

- Capacity to produce 1 million young plants per year

**CULTIVATION - INDOOR - THC** **3.7M** Annually

INDOOR FACILITY 12,400 SF

**PLANNED EXPANSION REVENUE** **110M** Annually

24 GREENHOUSES

- 22 Cultivation and nursery Greenhouses
- 2 Rooting stations strategically located within the state





# USE OF FUNDS

**Site Development - 1.7M**

**Greenhouse Buildout - 2M per greenhouse**

**Marketing Expenses - 1.5M**

**Permitting and Licensing Fees - 150k**

**Transactional Expenses - 300k**

**Operational Expenses and Overhead - 600k**

